

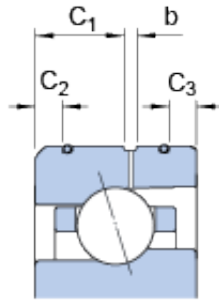

# SGS BEARINGS IMPORT LTD.

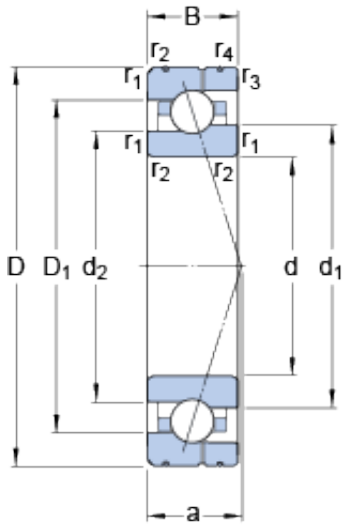

## 75 mm x 115 mm x 20 mm SKF 7015 CE/HCP4AL angular contact ball bearings

Bearing No. 7015 CE/HCP4AL

7015 CE/HCP4AL Bearing 2D drawings and 3D CAD models

Size	115x75x20 mm
Bore Diameter	115 mm
Outer Diameter	75 mm
Width	20 mm
d	75 mm
D	115 mm
B	20 mm
d <sub>1</sub>	89.28 mm
d <sub>2</sub>	86.8 mm
D <sub>1</sub>	100.72 mm
b	1.8 mm
C <sub>1</sub>	10.9 mm
C <sub>2</sub>	3.4 mm
C <sub>3</sub>	3.4 mm
r <sub>1,2</sub> - min.	1.1 mm
r <sub>3,4</sub> - min.	0.6 mm
a	22.8 mm
d <sub>a</sub> - min.	81 mm
d <sub>b</sub> - min.	81 mm
D <sub>a</sub> - max.	109 mm
D <sub>b</sub> - max.	110.8 mm
r <sub>a</sub> - max.	1 mm
r <sub>b</sub> - max.	0.6 mm
d <sub>n</sub>	91.5 mm



## SGS BEARINGS IMPORT LTD.

Basic dynamic load rating - C	26 kN
Basic static load rating - C <sub>0</sub>	21.6 kN
Fatigue load limit - P <sub>u</sub>	0.915 kN
Limiting speed for grease lubrication	19000 r/min
Limiting speed for oil lubrication	29000 mm/min
Ball - D <sub>w</sub>	9.525 mm
Ball - z	26
G <sub>ref</sub>	8.6 cm <sup>3</sup>
Calculation factor - f <sub>0</sub>	9.5
Preload class A - G <sub>A</sub>	140 N
Preload class B - G <sub>B</sub>	420 N
Preload class C - G <sub>C</sub>	840 N
Calculation factor - f	1.1
Calculation factor - f	1
Calculation factor - f <sub>2A</sub>	1
Calculation factor - f <sub>2B</sub>	1.03
Calculation factor - f <sub>2C</sub>	1.05
Calculation factor - f <sub>HC</sub>	1.01
Preload class A	72 N/micron
Preload class B	113 N/micron
Preload class C	156 N/micron
d <sub>1</sub>	89.28 mm
d <sub>2</sub>	86.8 mm
D <sub>1</sub>	100.72 mm
C <sub>1</sub>	10.9 mm
C <sub>2</sub>	3.4 mm
C <sub>3</sub>	3.4 mm
r <sub>1,2</sub> min.	1.1 mm



## SGS BEARINGS IMPORT LTD.

$r_{3,4}$ min.	0.6 mm
$d_a$ min.	81 mm
$d_b$ min.	81 mm
$D_a$ max.	109 mm
$D_b$ max.	110.8 mm
$r_a$ max.	1 mm
$r_b$ max.	0.6 mm
$d_n$	91.5 mm
Basic dynamic load rating C	26 kN
Basic static load rating $C_0$	21.6 kN
Fatigue load limit $P_u$	0.915 kN
Attainable speed for grease lubrication	19000 r/min
Attainable speed for oil-air lubrication	29000 r/min
Ball diameter $D_w$	9.525 mm
Number of balls z	26
Reference grease quantity $G_{ref}$	8.6 cm <sup>3</sup>
Preload class A $G_A$	140 N
Static axial stiffness, preload class A	72 N/ $\mu$ m
Preload class B $G_B$	420 N
Static axial stiffness, preload class B	113 N/ $\mu$ m
Preload class C $G_C$	840 N
Static axial stiffness, preload class C	156 N/ $\mu$ m
Calculation factor f	1.1
Calculation factor $f_1$	1
Calculation factor $f_{2A}$	1
Calculation factor $f_{2B}$	1.03
Calculation factor $f_{2C}$	1.05
Calculation factor $f_{HC}$	1.01



## SGS BEARINGS IMPORT LTD.

Calculation factor $f_0$	9.5
Mass bearing	0.59 kg